

GL-LED Down Light Series

User's Manual

Thank you for choosing the GL-LED Down Light Series LED products. Please install and use the products according to the following directions to ensure normal function and operation. If you do not follow these instructions to properly install and use the GL-LED Down Light Series, you will not be eligible for warranty compensation or protection. We do not take any responsibility for product damage resulting from improper installation or abnormal usage.



* For 3 in 1 dimmable function

- "DIM+ / DIM-" Connecting a variable resistor (10K~100K resistor) / 1~10Vdc Direct Voltage or a 10V / PWM signal can adjust the dimmable lighting.
 - Connecting "DIM+ / DIM-" to "AC L / AC N" may damage the Lighting.
 - When the control cable "DIM+ / DIM-" is open, LED Light output is 100%.
 - The 3 in 1 Dimmer is not capable of turning off the LED light completely. To turn off the light, we would recommend you to use the dimmer with a switch.
- For detailed 3 in 1 dimmable function description, please visit the web site: <http://www.glaciallight.com/products/PDF/3in1Dimming-Function.pdf>



Installation Guidelines

1. Unpack the GL-LED Down Light from the packaging box.
2. Take out the LED driver and the LED Down Light with caution.
3. Connect the LED driver and the LED Panel Light into the DC power cord connector (red to red, black to black). Do not connect the LED Panel Light into any other non-compatible LED driver which may cause product damage.

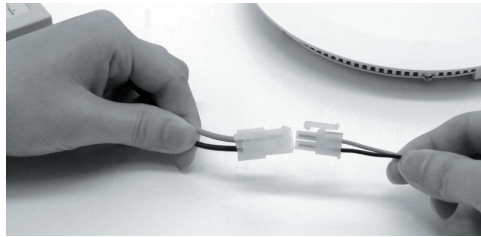

4. The DC power cord connector should be properly connected, not loose.

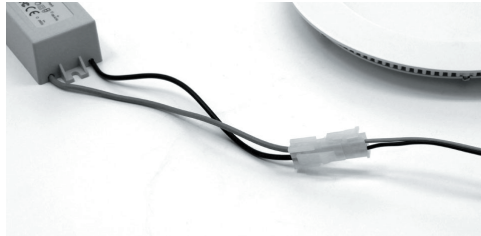

Instructions

To ease the installation process and ensure the optimal performance of the product, carry out the installation procedure in compliance with the following safety regulations.

- Unpack carefully and ensure there is no product damage during shipping. Should the product be found damaged during shipping, please return it to your supplier.
- Unless otherwise specified, never connect the device with any dimmer switch.
- All the electrical wiring necessary for the proper installation of the LED Down Light is supposed to be conducted by qualified personnel to prevent electric shock or product damage.
- Avoid humidity. Should the LED Down Light be moistened by any liquid or fluid that may conduct electricity, immediately disconnect it from the power source.
- In case of a malfunction, turn off the power source immediately. Never try to repair the LED Down Light by yourself which may cause serious damage and void your warranty. Instead, contact your local dealer for technical assistance.
- Please recycle the package.

Lamp

- Never touch the luminaire when it turns on or gets hot.
- Unless otherwise specified, never use LED luminaires in humid environments.
- Appropriate ambient temperature: -20 to 40°C

Troubleshooting

- **One of the following problems may appear while you use the LED lamp:**

- * **No light:** Check whether your LED lamp and all other accessories are properly fitted into the fixture adequately connected to the specified power source.
- * **Fixture Cleaning:** To optimize the light output, we recommend that you periodically clean the internal and external optical lenses as well as the reflection mirrors. Only use a dry soft cloth, a dust brush or a vacuum cleaner and never use any liquid chemical cleaner or water to clean the lamp.

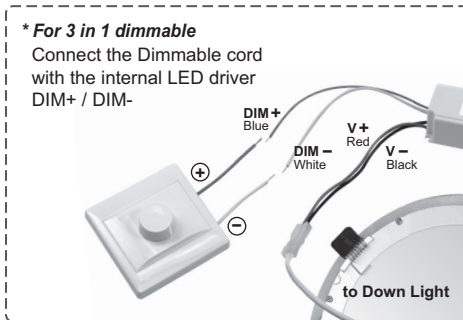

* Connecting "DIM+ / DIM-" to "AC L / AC N" may damage the Lighting.

5. Turn off the main power source before installation to avoid electric shock. Then properly insert Line (L) and Neutral (N) into the AC power connector.
6. The AC power connector should be properly connected, not loose.



7. Carve a hole according to the dimension of the LED light on the ceiling.

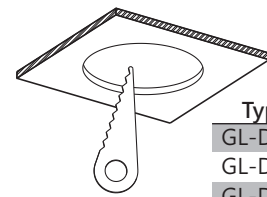

Type	hole size
GL-DL04	Ø100mm
GL-DL06-IP	Ø152mm
GL-DL06	Ø165mm
GL-DL08-IP	Ø200mm
GL-DL08	Ø225mm
GL-DL10	Ø285mm

8. Carefully place the LED driver through the hole and securely hook the spring frames onto the edge of the carved hole.

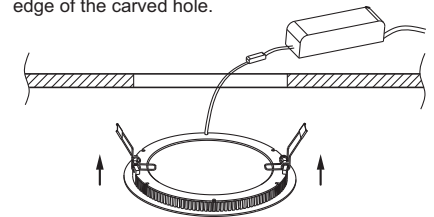

9. Turn on the AC power to light up the LED Down Light.

CAUTIONS

1. If the external flexible cable or cord of this luminaire is damaged, it shall be exclusively replaced by the manufacturer or his service agent or a similar qualified person in order to avoid a hazard.
2. Prior to installation, remove the AC power.

GL-DL 系列 使用手冊

感謝您選擇使用GL-DL平板燈系列LED燈具。請您依據下列說明指示來安裝本產品以確保本產品的正常運作。如您未按說明指示妥善安裝以及正常使用，您的產品將無法得到正常的保修補償。不正常的安裝與使用所造成的產品損壞，本公司具免責權利。

* 3合1調光功能說明

- 在DIM+和DIM-之間連接一個可變電阻(10K~100K resistor)或連接1~10Vdc直流電壓或10V/PWM信號，可調整亮度。
- 勿將DIM+/DIM-與AC L/AC N相連接，這樣會造成LED驅動器損壞。
- 當控制線DIM+/DIM-開路(open)時，亮度輸出為100%。
- 3合1調光驅動器不能將LED照明完全關閉(0%)，要達到LED照明完全關閉(0%)建議使用含有開關(SW)的調光器。

相關詳細3合1調光功能說明，請至：<http://www.glaciallight.com/products/PDF/3in1Dimming-Function.pdf>



安裝指南

1. 拆解GL-Down Light系列包裝箱。
2. 將LED電源驅動器與GL-Down Light系列平板燈小心地取出包裝箱。
3. 將LED電源的DC輸出連接器與平板燈相連接(紅線對紅線，黑線對黑線)。切勿將LED平板燈接上任何不匹配的電源驅動器以免造成產品毀損。

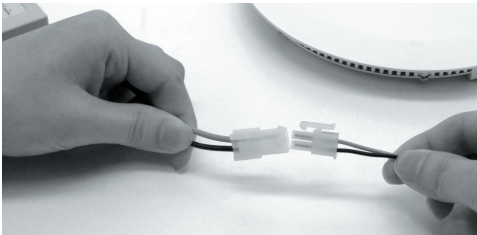

4. 承上，連接器接應妥善接合，不應鬆動。

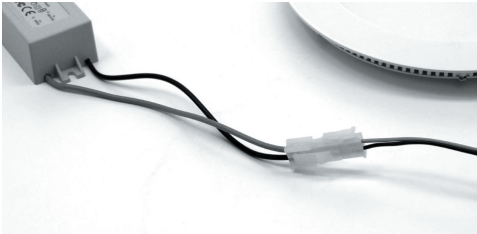

* 3合1調光功能 連接調光線到電源驅動器 DIM+ / DIM-

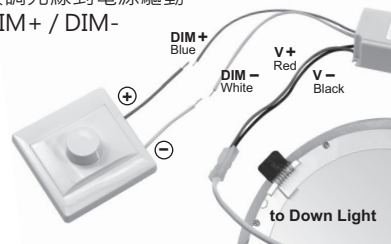

* 勿將DIM+/DIM-與AC L/AC N相連接，這樣會造成LED驅動器損壞。

5. 安裝GL-DL平板燈前應先將主電源關閉以避免安裝人員觸電。將交流電源線接至LED電源驅動器的AC輸入L(黑)/棕，N(白)/藍。
6. 承上，應妥善將交流電源線連與LED電源驅動器AC端相接，不可鬆動。



7. 依據LED燈的型號建議挖孔尺寸在天花板上進行挖孔。

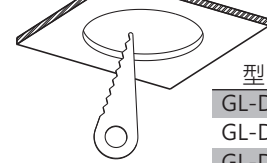

型號	挖孔尺寸
GL-DL04	Ø100mm
GL-DL06-IP	Ø152mm
GL-DL06	Ø165mm
GL-DL08-IP	Ø200mm
GL-DL08	Ø225mm
GL-DL10	Ø285mm

8. 將燈具彈簧向上扳直，並將燈具向上推進嵌孔內。彈簧會自然夾住板厚。

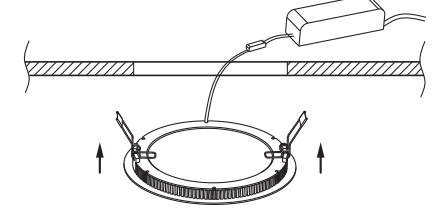

9. 打開開關啟動GL-Down Light。

指示說明

為了本產品安裝便利性與產品最佳表現，請遵照下列安全規定執行安裝。

- 小心地拆卸包裝並確認運送過程中產品無造成損害。若發現任何運送損害請退回給供應廠商。
- 除特別指定，勿將本產品連接至調光開關。
- 任何關於電氣特性的連接或安裝，請委由合格的施工人員進行，以避免人員或產品傷害。
- 任何因液體接觸造成本產品潮溼皆會有導電情況，請即刻移除電源。
- 萬一發生故障，請即刻關閉電源。切勿試圖逕行修復本產品否則將可能導致產品嚴重損壞與喪失保固。應聯絡您的經銷商尋求技術協助。
- 請回收包裝材料。

燈具使用注意事項

- 燈具點亮或發熱時，請勿觸碰燈具。
- 除特別指定，不要將燈具安裝在潮溼的環境。
- 適合安裝的環境溫度為-20~40°C。

故障排除

- 當你使用燈具時，可能會出現以下問題

* 燈具不亮

請檢查燈具的電源線是否適切地連接。

* 燈具清潔

建議周期性地以乾軟布擦拭、塵刷或吸塵器清潔燈具，勿用水或化學液體清潔燈具。

警告

1. 如果燈具外部纜線有損壞，應當由製造商、代理商或符合資格的施工人員做更換，以避免危險。
2. 安裝前，請確實關閉交流電源。

