

# GL-CFD06DA-35 Installation of Color Ring Accessory

## 彩色環安裝使用說明書

Thank you for choosing the GL-CFD06DA-35 Series LED products. Please install and use the products according to the following directions to ensure normal function and operation. Please use stainless screw to fix holder and make sure screwed tightly. If you do not follow these instructions to properly install and use the GL-CFD06DA-35, you will not be eligible for warranty compensation or protection. We do not take any responsibility for product damage resulting from improper installation or abnormal usage.

感謝您選擇使用GL-CFD06DA-35系列LED燈具。請您依據下列說明指示來安裝本產品以確保本產品的正常運作。請勿增加或刪除任何電子元件，未經許可勿更改或修改電氣設計。如您未按說明指示妥善安裝以及正常使用，您的產品將無法得到正常的保修補償。不正常的安裝與使用所造成的產品損壞，本公司具免責權利。

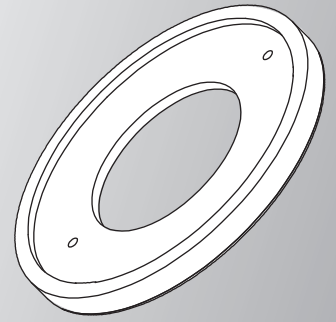

### Steps/步驟



Make sure to turn off the power before installing.

安裝前，請確實關閉電源。

During the process of installation, we suggest to wear the clean gloves and do not touch the LED CoB.

安裝過程中，建議穿戴乾淨的手套，並且請勿觸摸LED CoB。

### Step 1.

(a.) Unscrew the M3 screw indicated in the diagram to remove the reflector.

(b.) Spin the reflector clockwise and pull directly downward to remove it from the fixture.

(a.) 將反射杯內的M3螺絲取下備用。

(b.) 依箭頭方向旋轉將反射杯取下。

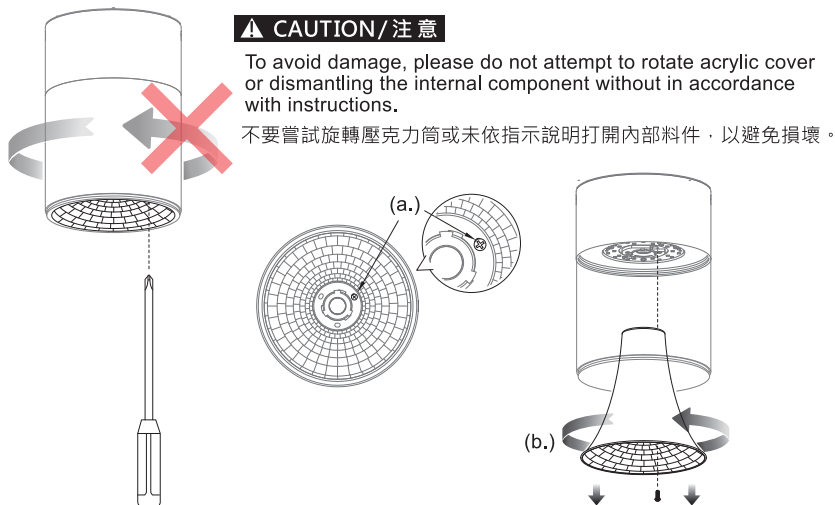

### Step 2.

Install the color ring onto the fixture and tighten it with the two M3 screws.

將彩色環以M3螺絲固定在燈具本體上。

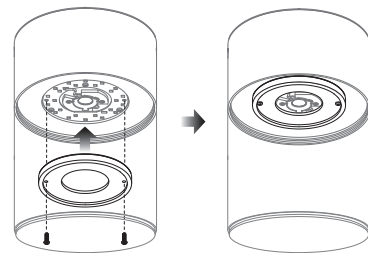

### Step 3.

(a.) Align the reflector back in the center of the fixture. Make sure the latches line up.

(b.) Tighten by rotating the reflector according to the diagram.

(c.) Fix the reflector with by replacing the M3 screw in the step 1.

(a.) 將反射杯對準中心卡榫位置。

(b.) 依箭頭方向旋轉使螺絲孔對準，將反射杯旋入卡榫中。

(c.) 以步驟1卸下的M3螺絲，將反射杯固定在燈具上。

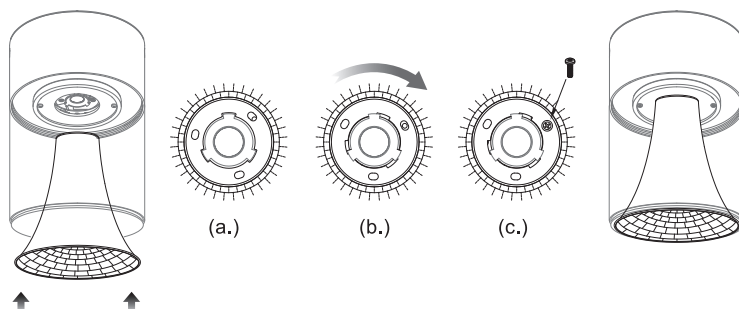

### Step 4.

Installation completed.

完成安裝。

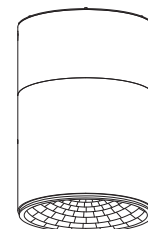

© 2016 GlacialTech Inc.

All rights reserved. All brand names and trademarks are the properties of their respective owners.

The specifications are subject to change without notice.

For further information please visit official website : [www.GlacialLight.com](http://www.GlacialLight.com)

版權所有 翻印必究 本說明書內容如有變更恕不另行通知。欲瞭解更多資訊，請參閱官方網站：[www.GlacialLight.com](http://www.GlacialLight.com)



BR

# GL-CFD06DA-35C Installation of Color Ring Accessory 彩色環安裝使用說明書(玻璃燈罩) (frosted reinforced glass)

Thank you for choosing the GL-CFD06DA-35 Series LED products. Please install and use the products according to the following directions to ensure normal function and operation. Please use stainless screw to fix holder and make sure screwed tightly. If you do not follow these instructions to properly install and use the GL-CFD06DA-35, you will not be eligible for warranty compensation or protection. We do not take any responsibility for product damage resulting from improper installation or abnormal usage.

感謝您選擇使用GL-CFD06DA-35系列LED燈具。請您依據下列說明指示來安裝本產品以確保本產品的正常運作。請勿增加或刪除任何電子元件，未經許可勿更改或修改電氣設計。如您未按說明指示妥善安裝以及正常使用，您的產品將無法得到正常的保修補償。不正常的安裝與使用所造成的產品損壞，本公司具免責權利。

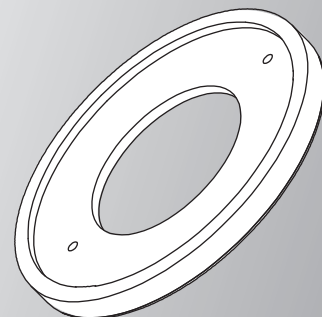

## Steps/步驟



Make sure to turn off the power before installing.

安裝前，請確實關閉電源。

During the process of installation, we suggest to wear the clean gloves and do not touch the LED CoB.

安裝過程中，建議穿戴乾淨的手套，並且請勿觸摸LED CoB。

### Step 1.

Remove the acrylic cover by rotating it clockwise.

依箭頭方向將壓克力筒旋轉下。

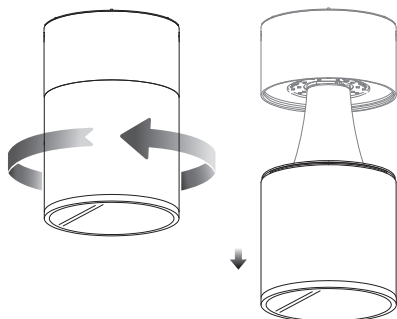

### Step 2.

(a.) Unscrew the M3 screw indicated in the diagram to remove the reflector.

(b.) Spin the reflector clockwise and pull directly downward to remove it from the fixture.

(a.) 將反射杯內的M3螺絲取下備用。

(b.) 依箭頭方向旋轉將反射杯取下。

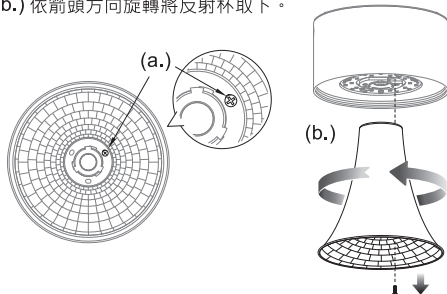

### Step 3.

Install the color ring onto the fixture and tighten it with the two M3 screws.

將彩色環以M3螺絲固定在燈具本體上。

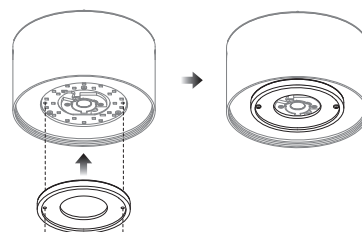

### Step 4.

(a.) Align the reflector back in the center of the fixture. Make sure the latches line up.

(b.) Tighten by rotating the reflector according to the diagram.

(c.) Fix the reflector with by replacing the M3 screw in the step 2.

(a.) 將反射杯對準中心卡榫位置。

(b.) 依箭頭方向旋轉使螺絲孔對準，將反射杯旋入卡榫中。

(c.) 以步驟二卸下的M3螺絲，將反射杯固定在燈具上。

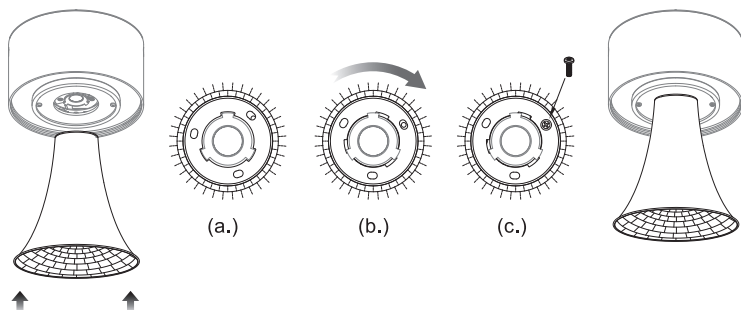

### Step 5.

Fasten the acrylic cover by pushing upward and rotating it counter-clockwise. Installation completed.

將壓克力筒依箭頭方向旋入燈具本體中，即完成安裝。

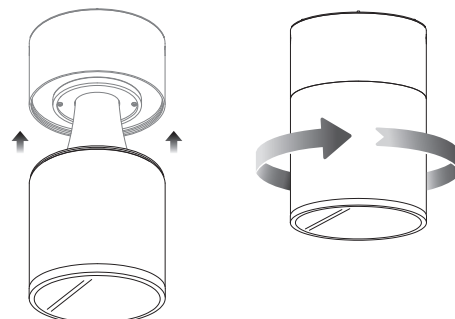

© 2016 GlacialTech Inc.

All rights reserved. All brand names and trademarks are the properties of their respective owners.

The specifications are subject to change without notice.

For further information please visit official website : [www.GlacialLight.com](http://www.GlacialLight.com)

版權所有 翻印必究 本說明書內容如有變更恕不另行通知。欲瞭解更多資訊，請參閱官方網站：[www.GlacialLight.com](http://www.GlacialLight.com)

